

Transport and Works Act 1992  
The Northumberland Line Order  
County of Northumberland

Land and Works Plan

Sheet No. 16 of 24

Key:

ORDER LIMITS

LAND TO BE ACQUIRED PERMANENTLY

Number on Plan  
186, 188, 189, 191, 192

Version No.  
V2.8

Where applicable the plot boundaries show the general boundary of the registered land. It does not show the exact line of the boundaries. Measurements scaled from this plan may not match measurements between the same points on the ground.

This map is based upon Ordnance Survey material with the permission of Ordnance Survey on behalf of the Controller of Her Majesty's Stationery Office © Unauthorised reproduction infringes crown copyright and may lead to prosecution or civil proceedings. Crown copyright and database rights 2022 Ordnance Survey. Licence number: 0100031673

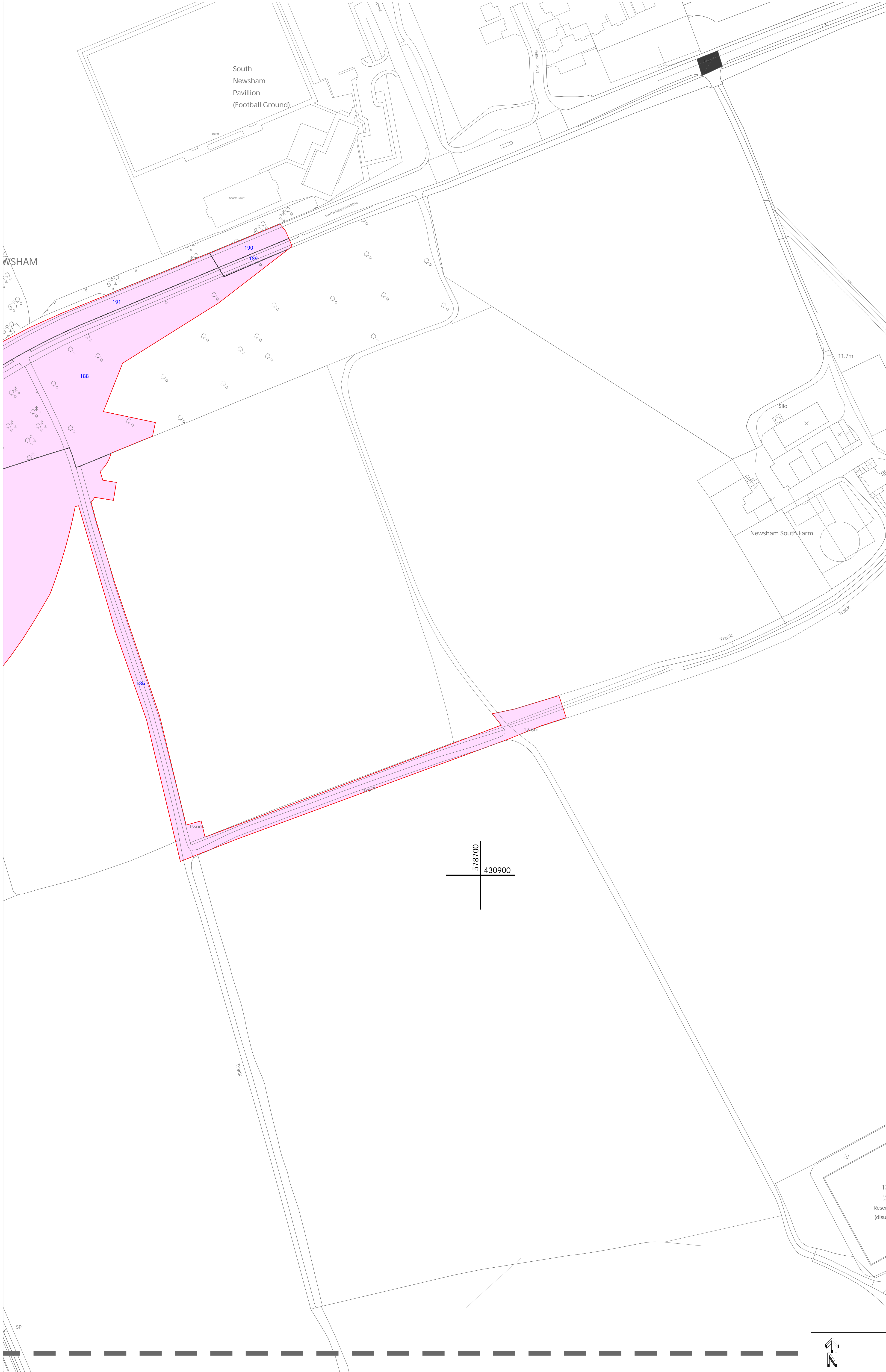

CUT LINE - FOR CONTINUATION SEE SHEET 15

Scale 1:1000 at A1

